



SOMERSET BUILDING Preservation Trust

‘SAVING No 9’

Discovery - History

LOCATION, HISTORY AND OWNERSHIP

PROVISIONAL PHASED GROUND FLOOR PLAN

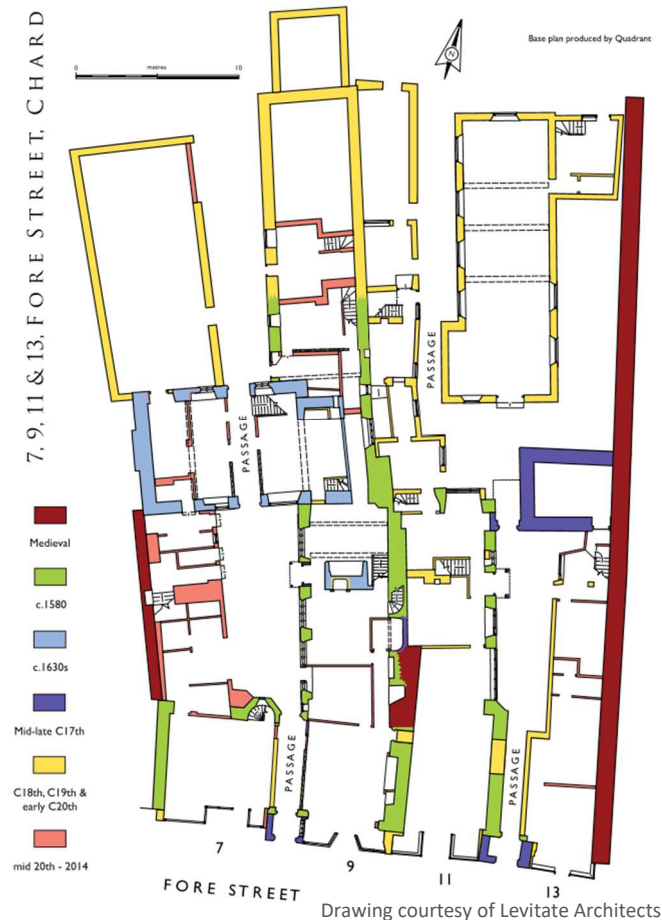

FIRST FLOOR PLAN



Photo ©P J Stow

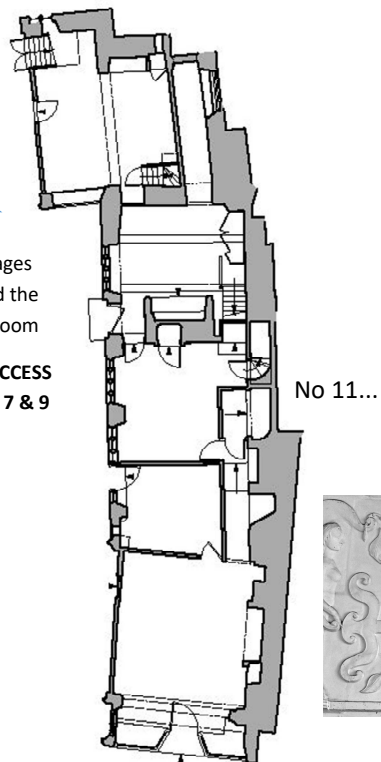

Fore Street

No 11...



Photo ©Bob Winn

GROUND FLOOR PLAN

Plans courtesy Levitate Architects

HOW YOU CAN HELP:

The **Somerset Building Preservation Trust** is a charitable organisation that repairs and restores buildings of historical interest which would otherwise be lost and brings them back into beneficial use within communities.

The Trust promotes higher standards of architectural design through its **William Stansell Historic Building Awards** and encourages the use of apprenticeships to teach traditional skills in conservation.

To learn more about the Trust and its work and how you can become involved with helping to save this most important building visit <https://www.sbpt.info/> and refer to the Somerset Building Preservation Trust YouTube Channel to see Episodes of "Saving No 9".

DONATION FORM

PAYMENT METHOD:

BACS preferred or see website for alternative payment details.

BARCLAYS Bank Plc Sort 20-99-40 Account 60544566 Ref No 9

NAME:

ADDRESS:

POSTCODE: PHONE:

GIFT AID DECLARATION

I confirm I have paid or will pay an amount of Income Tax and/or Capital Gains Tax for the current tax year (6 April to 5 April) that is at least equal to the amount of tax that all the Charities and Community Amateur Sports Clubs that I donate to will reclaim on my gifts for the current tax year. I understand that other fees such as VAT and Council Tax do not qualify. I understand the Charity will reclaim 25p of tax on every £1 that I have given. **THANK YOU.**

SIGNED: DATED:

OUR AIM:

... is to Conserve No 9 Fore Street and Connect the wider Community with Centuries of History in the Centre of Chard.

OUR MISSION:

... is to engage with the diverse population of Somerset, tailor the repairs and alterations to this historically important building to suit a communal purpose for the widest benefit and ensure the best quality workmanship to secure the building for future centuries.



No 9 Fore Street, Chard, with a common entrance (left). Photo ©P J Stow

ABOVE: The white shop front currently 'The Hub - A Community Service Company'. No 9 is a Listed Grade 1 Elizabethan town house with first floor Courtroom containing a heavily decorated plaster ceiling all set behind this 'L' shaped three storey building.



**SAVING No 9:
OPTIONS APPRAISAL**
29th January 2024

Thread

THREAD - 35 FORE STREET, WELLINGTON TAZI BAG

PROGRESS SINCE LEASE ACQUISITION in May 2023

Five High Street Heritage Action Zone grant aided repair projects completed to make the building watertight.

Viability Appraisal Options Report completed grant funded by the Architectural Heritage Fund (AHF).

Project Development Grant awarded by Architectural Heritage Fund (AHF) for completion by March 2025. Thread Architects recently appointed to lead the Design Team for this task to RIBA Stage 2.

Historic England Capacity Building Grant initial stage for SBPT to increase office staff capacity to confirm the Project Co-ordinator role for No 9 project.

Clearance of building contents, access now throughout.

Local Film Company continues to document progress of the project as showing on Youtube channel @SBPT-tv

SURVEYS & VISITS

Laser Scan survey completed internally, point cloud data provides detailed views. Somerset Vernacular Buildings Group surveys of timberwork and 1st floor structure.

Somerset Archaeological and Natural History Society inspections of stonework. Historic England inspections and consultations.

Tours of ten groups of Architects bidding to lead the PDG funded Design team.

SBPT & Chard Museum members visits

Members of the public and work experience placements.

Institution of Historic Building Conservation and Society for Protection of Ancient Buildings group visits.

Plaster specialist inspection of Courtroom decorative 1631 plasterwork.

Multiple updates to background research material continues throughout.



ABOVE: Ceiling central decorative plaster pendant in the Courtroom. Photo ©P J Stow

LEFT: Image taken from drone survey used to highlight No 9 location within the multi owned complex of Grade 1 buildings.

#02 - July 2024 Designed, published and printed in house by The Somerset Building Preservation Trust



www.sbpt.info



YouTube

<https://www.youtube.com/@SBPT-tv>

SOMERSET BUILDING PRESERVATION TRUST



SOMERSET COUNCIL



CHARD TOWN COUNCIL



SWHT



The Hub

